

VIEW B-B  
SCALE 1 : 1

NOTE:  
AAR APPROVAL # E-182113.

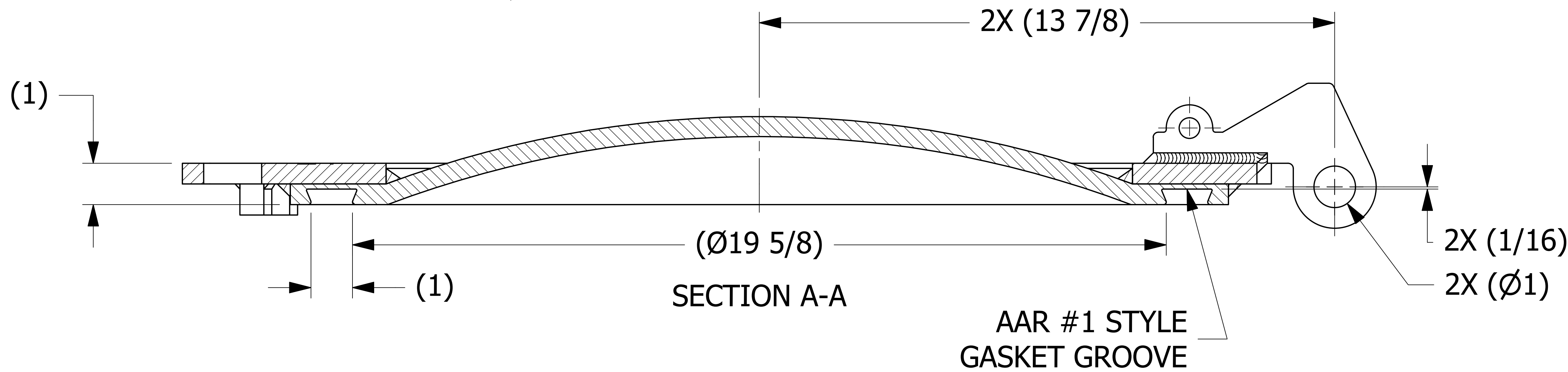

UNLESS OTHERWISE SPECIFIED  
DIMENSIONAL TOLERANCES  
FRACTIONAL:  $\pm 1/16$   
X.XX:  $\pm .03$   
X.XXX:  $\pm .015$   
ANGULAR:  $\pm 1^\circ$   
DEBURR ALL SHARP EDGES.  
ALL MACHINED SURFACES TO  
HAVE A 125 RMS FINISH UNLESS  
NOTED OTHERWISE.

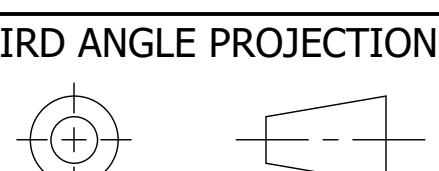

DRAWN BY: CHL  
CHECKED BY: VD  
PROTOTYPE BY: CHL  
PROTOTYPE DATE: 5/7/2009  
APPROVED FOR PRODUCTION BY: VD  
PRODUCTION DATE: 6/12/2009

K	CHL	1-29-19	REMOVED QAP4A-1 NOTE; Q-2.15.7 WAS QAP4C-1; REPLACED DSS 12 W/D-005 & D-008; AAR # WAS E-089004
J	RJP	11-16-17	HINGE WELD WAS 3/8"; 4.00 +.00/-.06 WAS 4.00; ADDED NOTE 6; ADDED "SALCO" TO ENGRAVING
I	WEB	9-12-17	REPLACED 2X C42810 W/ 2X C46023
H	RJP	7-24-17	UPDATED C42180 TO SLOTTED HOLE; WELD NOTE TO DSS 12
G	RJP	11-16-16	.06 WAS .13, 2X 1 1/8 WAS 2X (1 1/8)
F	RJP	10-10-16	TMCDR2045 WAS TMCR204C101 & TMCDSC1MF, A44194 WAS A29293
E	WEB	11-25-15	REPLACED TMCHS4A WITH 2X C42810, UPDATED TITLEBLOCK
D	CHL	1-11-12	ADDED NOTE #5 & HEAT/LOT NOTE
C	GDS	10-20-11	ADDED VIEW D-D
B	CHL	10-29-10	UPDATED NOTES, REPLACED A14392 W/A29293, UPDATEDWELD SYMBOL, ADDED PART NUMBER TO RING SURFACE
A	CHL	6-12-09	NEW PART ADDED TO SYSTEM
REV	BY	DATE	DESCRIPTION



PART NAME:  
**MANWAY COVER 20" 8-BOLT**

MATERIAL:  
**CARBON STEEL**

PROJECT #:  
**090326**

SHEET #:  
**1 OF 1**

SCALE:  
**2:3**

DRAWING #:  
**E26831**

PART #:  
**TMC204501**